

Automatic electric coffee grinder «ditting KFG»

OPERATING INSTRUCTIONS

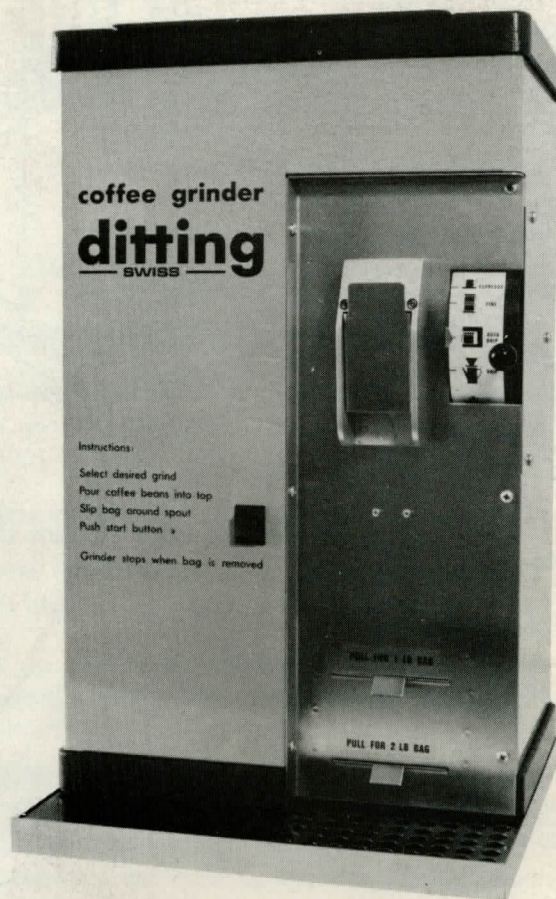

ditting
— SWISS —

The Ditting company, the specialists for industrial coffee grinders, have developed and are producing with Swiss precision the new coffee grinder model KFG. This coffee grinder has 12 important advantages:

- 5 grades of grind - ESPRESSO to COARSE -
- Minimal heatup of ground coffee
- Uniform blend of coffee grind
- Minimal amount of powder
- Design for safe operation
- safety guard in the hopper
- Very smooth operation
- Designed for long life, because of high quality materials
- Maintenance - free
- Thermal motor protection
- Functional, modern design
- Well arranged design
- Reasonably priced

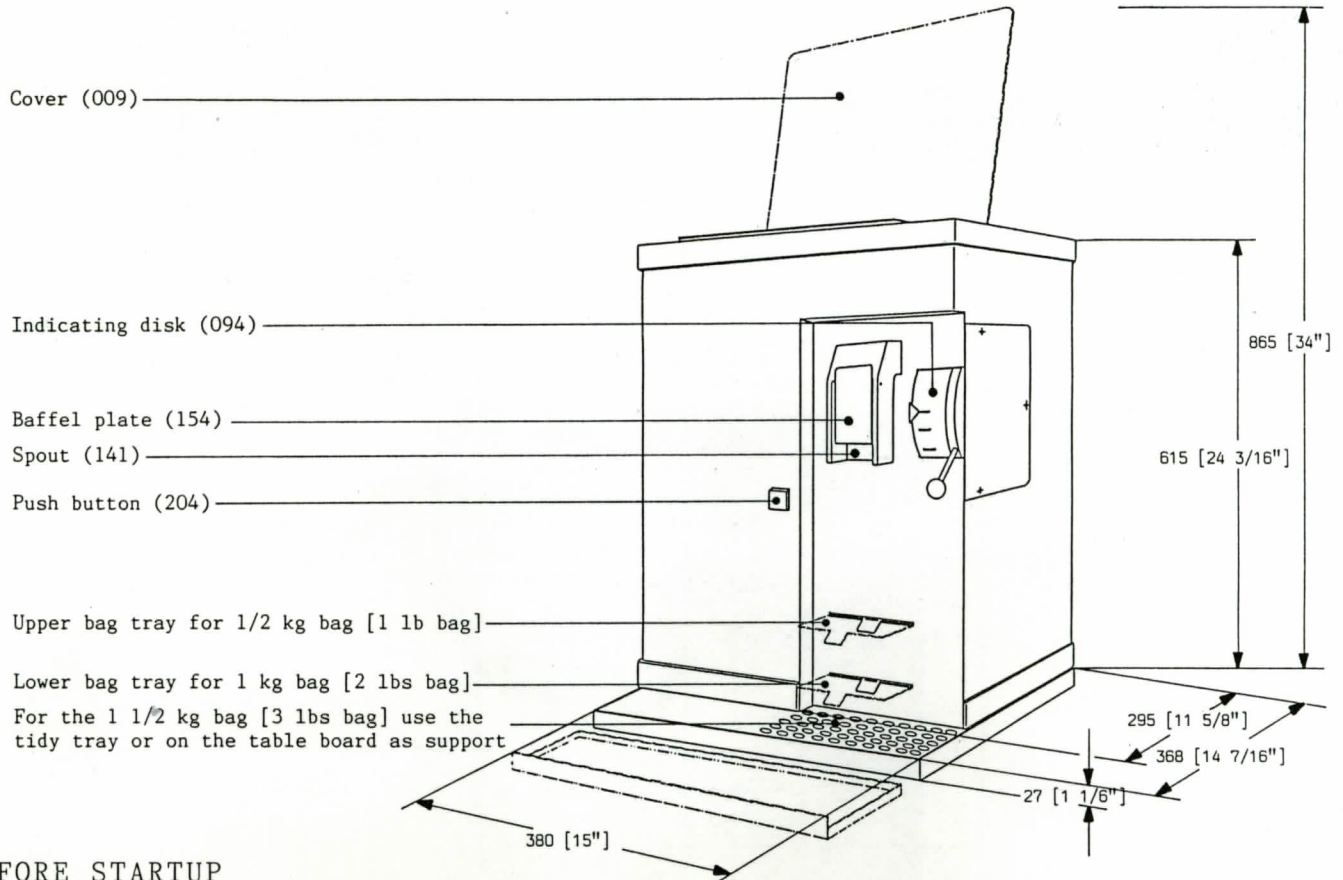

BEFORE STARTUP

Please check if line voltage, frequency and fuse protection corresponds with the markings on the rating plate.

STARTUP

- Adjust fineness of grind with the indicating disk (094).
- Open the cover (009), fill in coffee beans and close the cover (009).
- Slide empty paper bag over the spout (141) and pull the corresponding bag tray and operate the push button (204). Now the unit automatically goes thru the grinding process.
- When the grinding sound has ceased, hit the baffle plate (154) so that the remaining coffee falls in the paper bag.
- Take the paper bag away from the bag tray and pull it from the spout (141). The coffee grinder will be shut off automatically.
- The coffee grinder is now ready for a new grinding cycle.

TECHNICAL SPECIFICATIONS

- Voltage	120 VAC 60 Cycle	- Power consumption	0,9 kW [1,2 hp]
- Net weight		- Average output	1,0 kg/min [2,2 lbs/min]
Coffee grinder:	27,8 kg [62 lbs]	- Grinding disk - type	KFG 90/9 - KFG 90/10
Tidy tray with bottom plate:	2,5 kg [5,5 lbs]	- Grinding disk - diameter	90 mm [3 9/16"]

ACCESSORIES (additional price)

- Tidy tray with bottom plate complete part - number 3558 B
- Replacement grinding disks by pair part - number 3559 B

(When placing an order for spare - and accessory parts, it is absolutely necessary to indicate all the specifications from the rating plate.)

CHANGING OF THE GRINDING DISKS

After grinding 10 000 kg [22 000 lbs] of coffee beans the grinding disks have to be resharpened. It is possible to resharpen the grinding disks two times. We recommend to buy a spare pair of grinding disks part - number 3559 B

Only grinding disks produced or resharpened by the manufacturer are to be used (model KFG 90/9 - KFG 90/10)

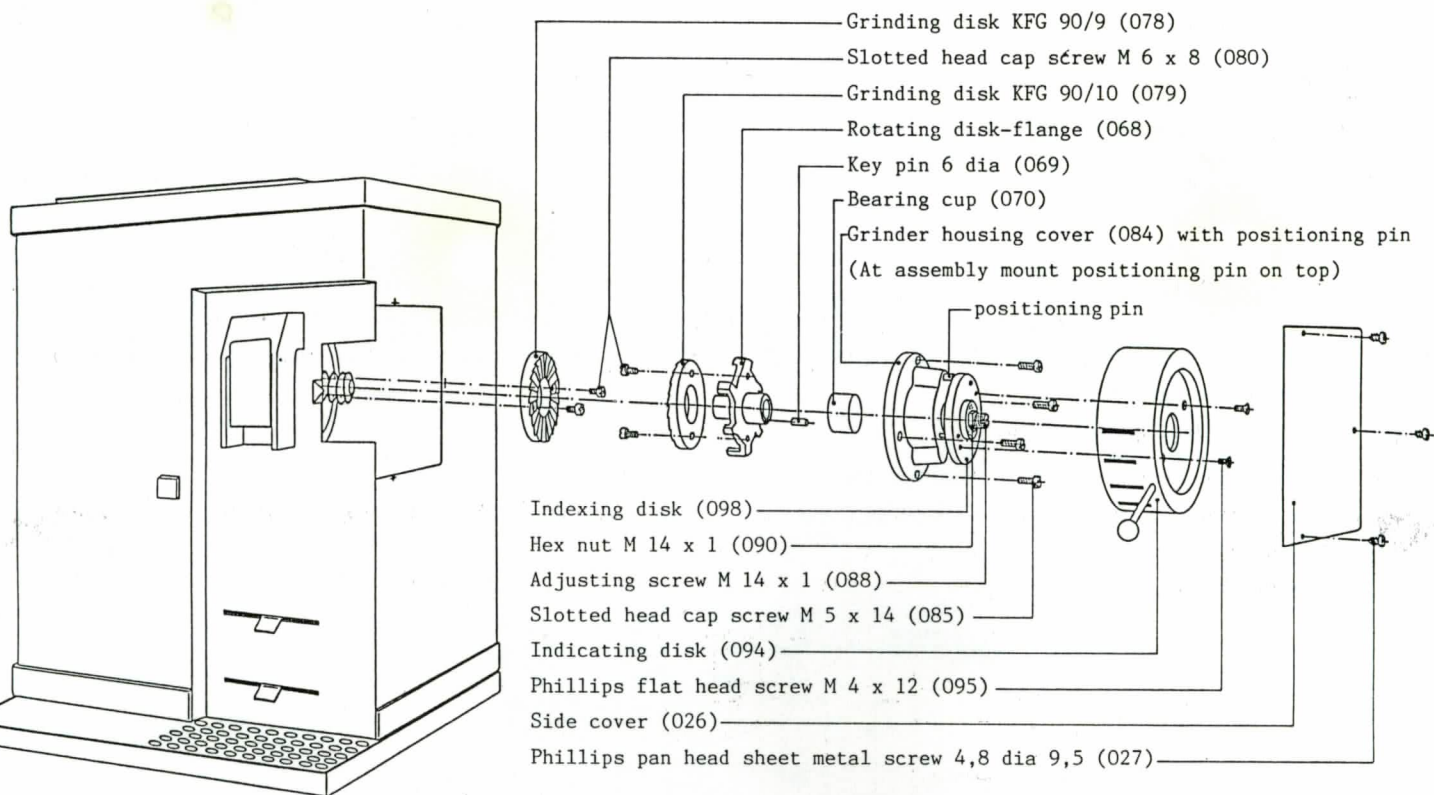

- Pull out the plug.
- With a Phillips screwdriver remove the 3 Phillips pan head sheet metal screws 4,8 dia x 9,5 (027) and take off the side cover (026).
- Turn the indicating disk (094) in the position -ESPRESSO- and remove the 2 Phillips flat head screws M 4 x 12 (095) with a Phillips screwdriver.

When removing the indicating disk (094), watch for not injuring the lettering.

- Release the hex nut M 14 x 1 (090) and turn the adjusting screw M 14 x 1 (088) counterclockwise for 3 to 4 turns (to the left)
- Remove the 4 slotted head cap screws M 5 x 14 (085), which are retaining the grinder housing cover (084) and take it off.
- Take off the bearing cup (070).
- Pull off the rotating disk-flange (068) from the shaft of the grinding gear.

Watch out for the key pin 6 dia (069), so as not to loose or damage it.

- Remove the grinding disk KFG 90/9 (078) from the grinder housing (076) and the grinding disk KFG 90/10 (079) from the rotating disk-flange (068).
- Carefully clean the mating surfaces of the 2 grinding disks KFG 90/9 (078) and KFG 90/10 (079) in the grinder housing (076) and on the rotating disk-flange (068), the 4 slotted head cap screws M 6 x 8 (080) and both grinding disks (078) and (079)
- If those faces are not cleaned properly, an uneven grinding quality may occur.
- Fasten now the new or resharpened grinding disks KFG 90/9 (078) in the grinder housing (076) and KFG 90/10 (079) at the rotating disk-flange (068) with the 4 slotted head cap screws M 6 x 8 (080).
- Assemble now the rotating disk-flange (068) with the grinding disk to the grinding shaft. Align the semiholes of the shaft and the rotating disk-flange (068) and insert the key pin 6 dia (069).

With the key pin 6 dia (069) inserted, the rotating disk-flange (068) must freely slide on the shaft.

- Push now the bearing cup (070) over the hub of the rotating disk-flange (068) and mount the grinder housing cover (084) to the grinding unit with the 4 slotted head cap screws M 5 x 14 (085). Watch for positioning pin of the grinder housing cover (084) to be on top.
- Now turn the indexing disk (098) counterclockwise (to the left) till the pin of the indexing disk (098) hits the positioning pin of the grinder housing cover (084). Mount the indicating disk (094) with setting -ESPRESSO- to the indexing disk (098) with the 2 Phillips flat head screws M 4 x 12 (095).
- Connect the plug to the receptacle, insert an empty paper bag between spout (141) and the relating tray and operate the push button (204). Now turn the adjusting screw M 14 x 1 (088) with a screwdriver clockwise (to the right) till you hear, that the grinding disks start interfering. Immediately turn the adjusting screw M 14 x 1 (088) counterclockwise 1/8 of one turn (to the left) and lock this position with the hex nut M 14 x 1 (090). This setting corresponds to -ESPRESSO- grind.
- Mount the side cover (026) to the housing with the 3 Phillips pan head sheet metal screw 4,8 dia x 9,5 (027).

MAINTENANCE INSTRUCTION

- The unit is normally maintenance free.
- Remaining coffee grind should daily be removed from coffee grinder and surrounding.
- Do not use aggressive cleansers.

TROUBLE SHOOTING

FOREIGN MATTERS IN GRINDING UNIT

- Disassemble the grinding unit with the same sequence as if replacing the grinding disks and remove the foreign matter. Inspect the grinding disks for damage and replace if necessary.

GRINDER IS NOT OPERATING

- Check if paper bag is operating the limit switch trip slide (151).
- Check if the drivemotor is overheating and if the thermal overload switch has tripped. In this case wait a few minutes till coffee grinder can be restarted.
- Check if fuse in feederline has blown.

Before opening the coffee grinder housing always pull the plug.

For maintenance on the electrical parts always consult an electrician. As first step always short out the capacitor.

The electrical schematic for the whole unit is on the inside of the side cover.

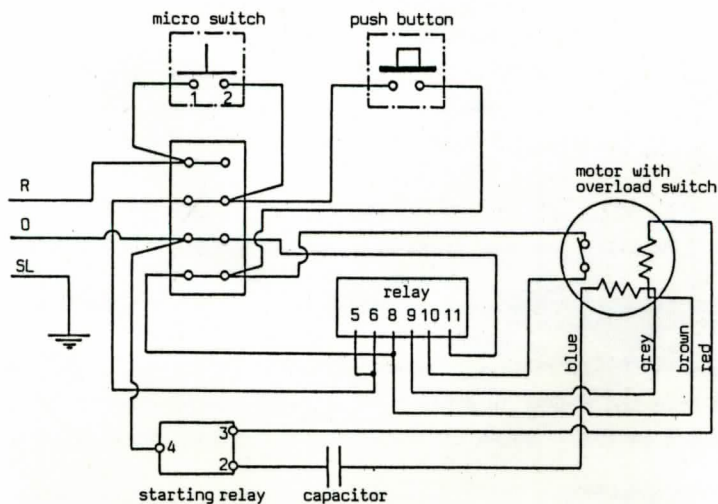

Be careful to connect the feeder cable exactly as indicated in the schematic.

GROUND COFFEE IS NOW LONGER COMING OUT OF SPOUT

- Disassemble the grinding unit as explained in section -FOREIGN MATTERS IN GRINDING UNIT- and clean the spout.

IMPORTANT NOTICE

We reserve the right to change certain components without notice. When ordering accessories or spare parts (all spare parts, also those which in the meantime have been changed, can be supplied at any time) always furnish all dates from the rating plate.

We do not accept any responsibility for damages due to not following these operating instructions.

Manufacturer DITTING AG
 Bramenstrasse 11
 CH-8184 Bachenbülach
 Switzerland
 Phone (01) 860 54 21/24
 Telex 58 889

Dealer/Service