

# Service Instruction – Burr replacement KE 640

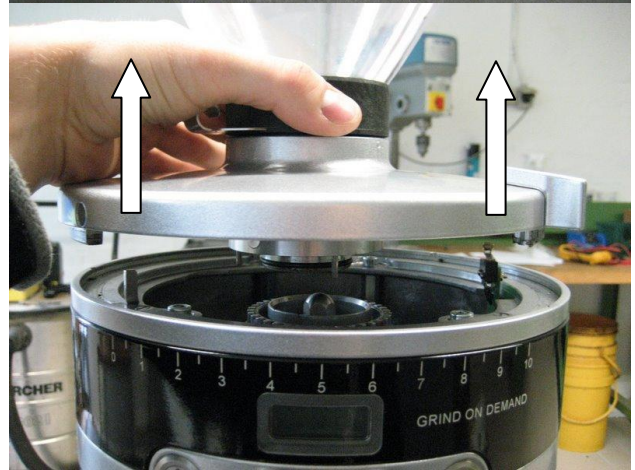

Caution: Read User Manual

1. Close hopper slider and grind through all remaining beans.
2. Switch off grinder and pull the main plug.
3. Loosen the safety screw in the lid, turn the grind adjustment to coarse and lift off the lid from the grinder.

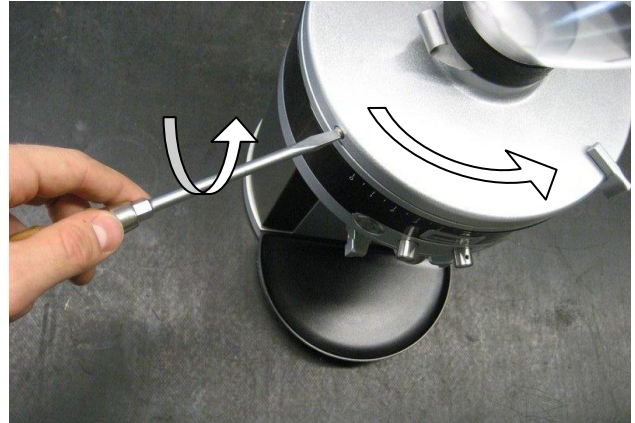

4. Screw open the grinder casing lid and take it off.

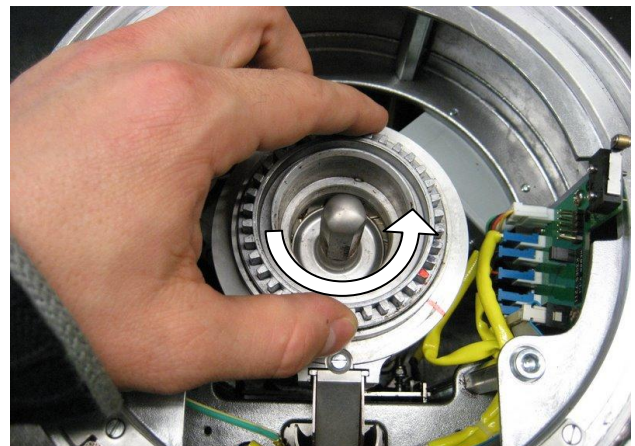

# Service Instruction – Burr replacement KE 640



5. Fix the moving burr carrier with a screw driver and unscrew the finger-protection.

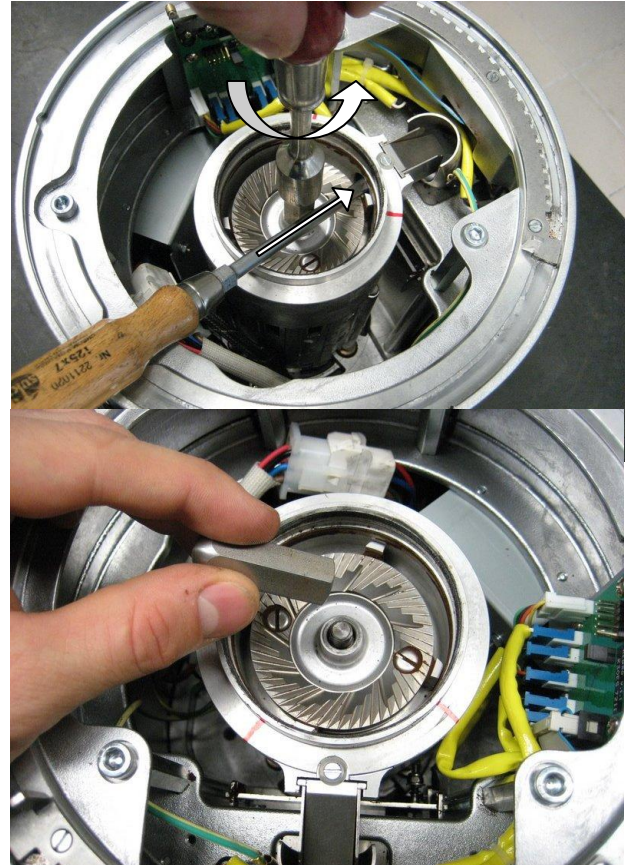

# Service Instruction – Burr replacement



## KE 640

6. Pull out the moving burr carrier.

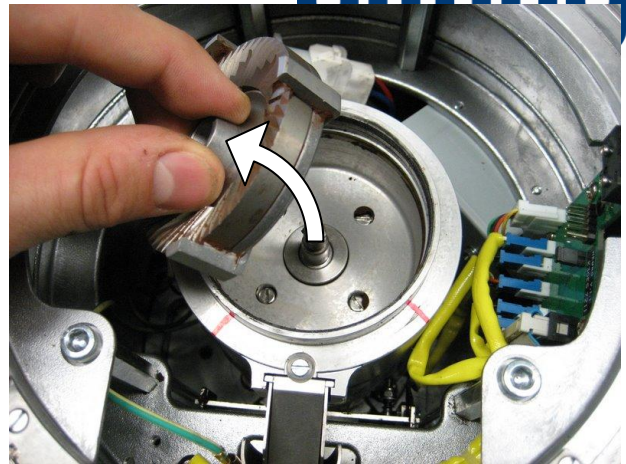

7. Spring-clean both burrs.

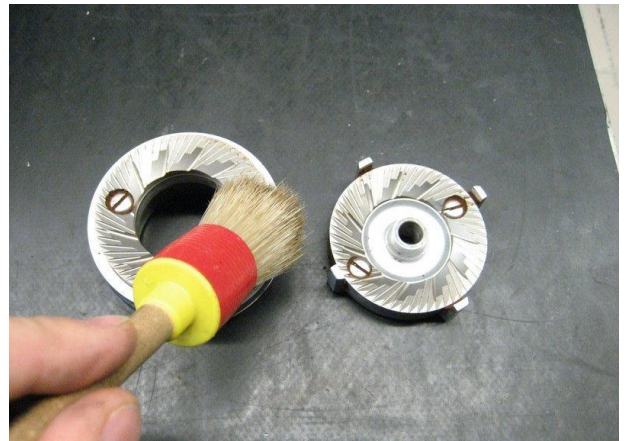

8. Unscrew the fixing screws and take off the burrs from the carriers. Spring-clean the carriers. No coffee residues are allowed between carrier and new burr.

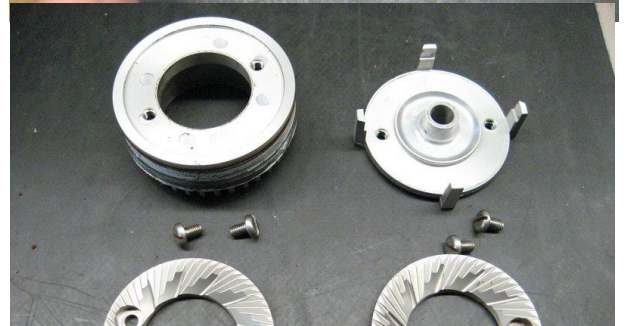

9. Fix new burrs onto the carriers. Please note the right assembly of the different burrs:  
S-1:fixed and D-1: rotary.

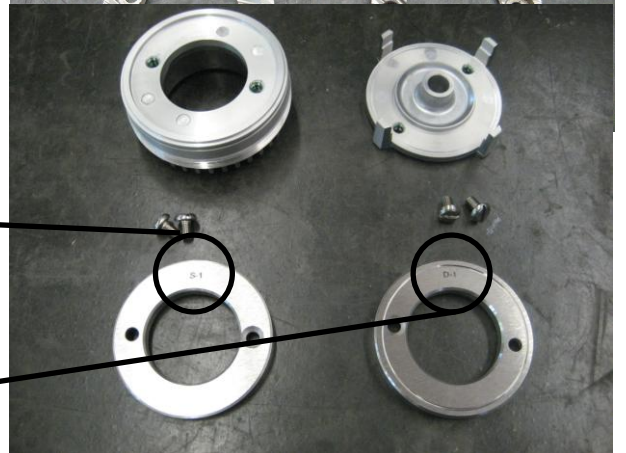

# Service Instruction – Burr replacement KE 640



10. Spring-clean the burr casing with brush.



11. Reassemble the moving burr carrier with the finger-protection onto the motor axis.
12. Screw the burr carrier (grinder casing lid) back in until the burrs touch each other, also spin the moving burr carrier with the finger-protection. Turn back the grinder casing lid just a little bit so the burrs spin free without touching each other.

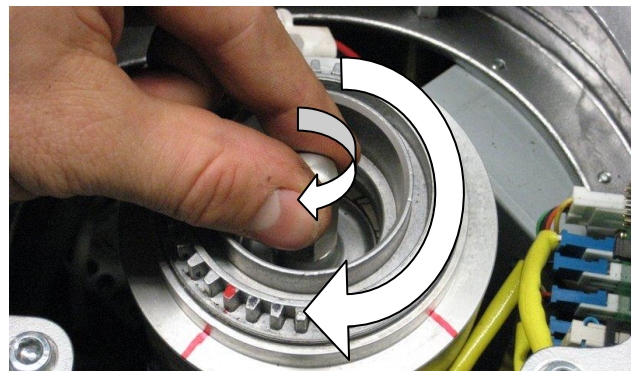

13. Remove the old red mark and set a new mark with a permanent marker.



# Service Instruction – Burr replacement KE 640



14. Turn the grinder casing lid anti-clockwise to the red mark 2 on the right (90°) for putting the grind adjustment lid back on.

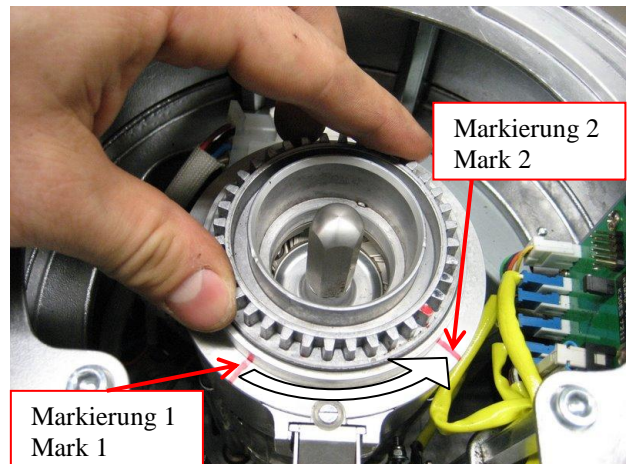

15. Reassemble the grind adjustment lid, fix the safety screw in the lid, adjust the grind adjustment to the finest setting 0, take off the hopper, take off the rubber gasket ring.

16. Loosen (do not unscrew) the fine-adjusting screws.



17. Insert the adjusting handle (special tool) into the filler shaft, with the slot of the handle engaging with the shaft's transverse bar.



# Service Instruction – Burr replacement KE 640



18. Switch on the grinder.
19. Start the grinder and slowly turn the adjusting handle clockwise until the burrs touch each other. A slight ringing noise is audible. Then turn the adjusting handle back until no further ringing sound can be heard.
20. Refix the fine-adjusting screws, put the rubber gasket ring back in the shaft, re-engage the hopper into the bayonet.

